

LPG TANKS

LPG Tank Clearance of Combustibles Weeds, grass, brush, trash and other combustible materials shall be kept a minimum of 10 feet from LP-gas tanks or Containers.

Protecting LPG containers from vehicles Where exposed to vehicular damage due to proximity to alleys, driveways or parking areas, LP-gas containers, regulators and piping shall be protected in accordance with NFPA 58.

VEHICLE IMPACT PROTECTION

General. Vehicle impact protection shall be provided by posts that comply with CFC Section 312.2 or by other approved physical barriers that comply with CFC Section 312.3

FIRE WATER STORAGE

If the project is determined to be located in the State Responsibility Area (SRA) fire water storage may be required.

FIRE SPRINKLERS (Where Required)

When Fire Sprinklers are required, three (3) sets of sprinkler plans with flow calculations and material cut sheets shall be submitted to Tehama County Fire Department for review **prior to the start of construction**. Sprinkler plans and calculations shall be done by a Licensed C-16 contractor.

For more information see Tehama County Ordinance (TCO) 2023 Chapter 9.14, TCO 1912 Chapter 9.05, Public Resources Code 4290 & 4291, California Fire Code, California Building Code, and California Residential Code.

Tehama County Fire Department's Fire Safe Requirements are posted on our website at <http://www.tehamacountyfire.org/>

Need a Fire Department inspection? Give us a call at (530) 527-7986

Driveway Requirements

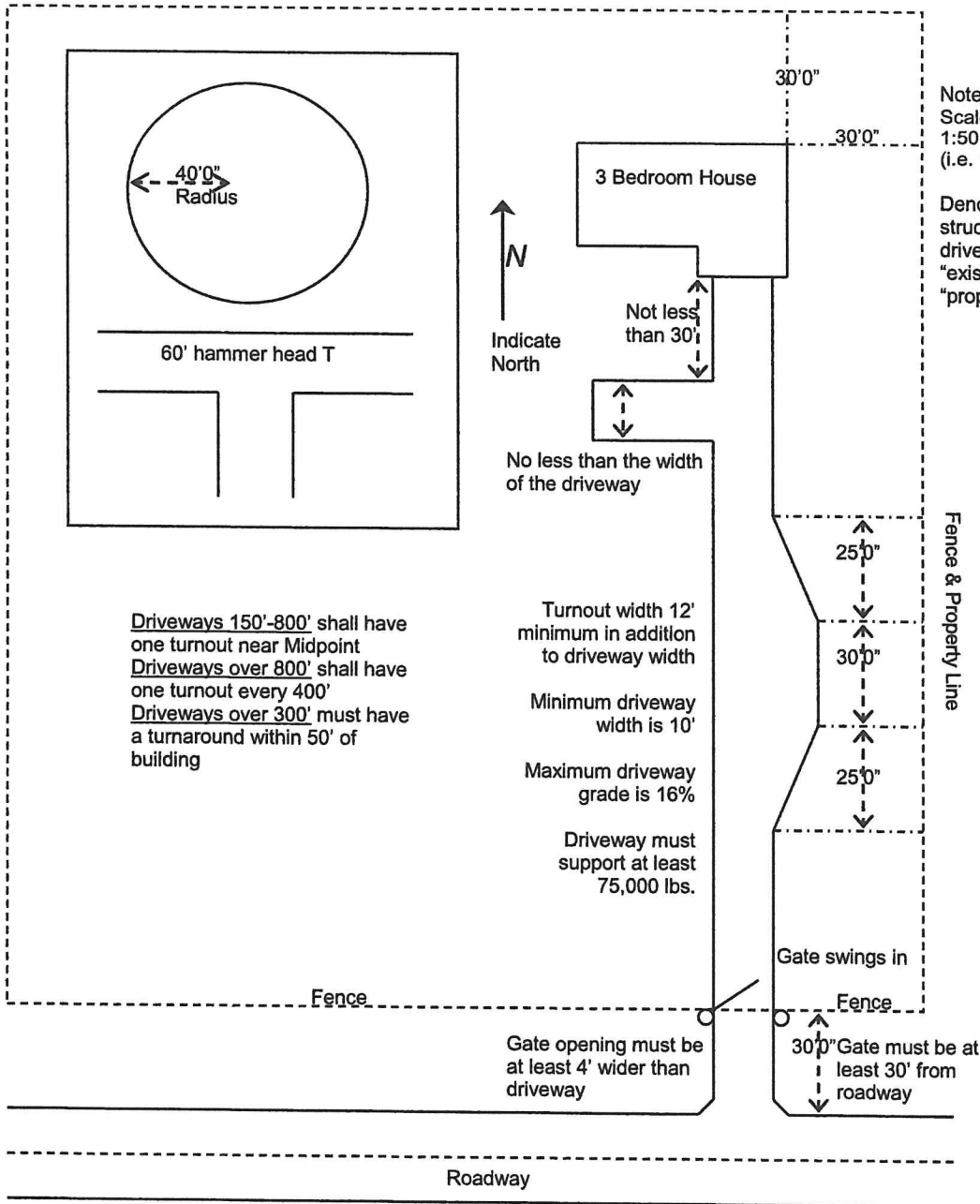

Driveways 150'-800' shall have one turnout near Midpoint
 Driveways over 800' shall have one turnout every 400'
 Driveways over 300' must have a turnaround within 50' of building

Tehama County Fire Department

Note:
 Scale should be 1:50 or finer (i.e. 1:40)

Denote each structure or driveway as "existing" or "proposed"

Address Requirements

